

Simply Starry Pillow

Finished size: 20 1/2" x 14 1/2"

Share your finished project on Instagram using #[simplystarrypillow](#)

Materials

Star points (white/neutral) 1/8 yard
Background (blue) 1/3 yard
*Scrappy top and bottom (piano key borders) Scraps to yield 1/4 yard
Backing 1/2 yard
Binding 1/4 yard
**If you do not want to do the scrappy top and bottom borders, just add a band of fabric the same color as the star points (see photo below). You will need 1/8 yard.*

Use inexpensive muslin backing to quilt the pillow top, and then reserve the 1/2 yard backing fabric for the envelope pillow back (instructions included). You will also need a 20" x 14" pillow form.

This is a **free pattern** from Carried Away Quilting. It is not intended to be sold. Quilt Shops may kit this pattern, but the pattern must be given free of charge to customers. Visit my website for patterns, free tutorials and other quilting fun!

www.carriedawayquilting.com



Carried
away
QUILTING

Simply Starry Pillow

A FREE PATTERN!

Finished size: 20 1/2" x 14 1/2"



Carried
away
QUILTING

Carried Away Quilting with Taunja Kelvington
carriedawayquilting.com
carriedawayquilting@gmail.com
[facebook.com/carriedawayquilting](https://www.facebook.com/carriedawayquilting)
Instagram: @taunjalynn

Simply Starry Pillow

Finished size: 20 1/2" x 14 1/2"

Sewing Instructions: Please read through all instructions before beginning. Sew pieces right sides together with 1/4" seam allowance. Fabric is assumed to have 42" usable width, unwashed. WOF means Width of Fabric. **Arrows show the suggested pressing direction.** For diagonal stitching, you may wish to use a quilter's pencil to mark this sewing line, or a guide on your machine, whichever you prefer. **Before you begin, check my website for any pattern updates.**

Cutting Instructions

White

Cut (1) strip 1 3/4" x WOF

- Subcut (24) squares 1 3/4" x 1 3/4"

Blue

Cut (2) strips 2 1/4" x WOF

- Subcut (12) squares 2 1/4" x 2 1/4"
- Subcut (12) rectangles 2 1/4" x 3"

Cut (1) strip 3" x WOF

- Subcut (3) squares 3" x 3"
- Subcut (2) strips 1 1/2" x 6 1/2"

Cut (1) strip 1 1/2" x WOF

- Subcut (2) strips 1 1/2" x 20 1/2"

Multiple colors/prints (piano key borders)

Cut (32) rectangles 1 3/4" x 3 1/2"

Alternate top/bottom borders (if not doing scrappy piano key borders)

Cut (2) strips 3 1/2" x 20 1/2"

This is a free pattern from Carried Away Quilting. It is not intended to be sold. Quilt Shops may kit this pattern, but the pattern must be given free of charge to customers.

Visit my website for patterns, free tutorials and other quilting fun!

www.carriedawayquilting.com



Assembly

1. Sew this unit using (1) blue rectangle 2 1/4" x 3" and (2) white 1 3/4" squares. (The dashed line is the stitching line. The red line is the trim line.) Each unit measures 2 1/4" x 3". Repeat to make 12 units.

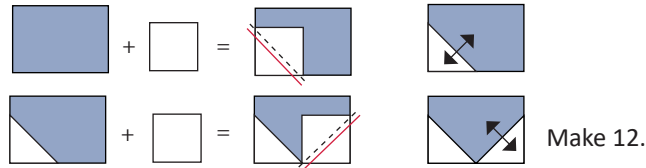

2. Sew a unit from step 1 to the left and right of a 3" blue square center. Each unit measures 3" x 6 1/2". Repeat to make 3 units.

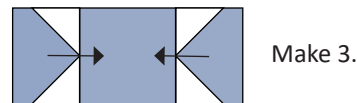

3. Sew (2) blue 2 1/4" squares to the left and right of a unit from step 1. Each unit measures 2 1/4" x 6 1/2". Repeat to make 6 units.

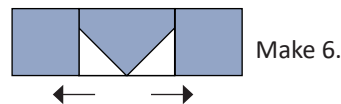

4. Sew the star block together. Each unit measures 6 1/2" x 6 1/2". Repeat to make 3 units.

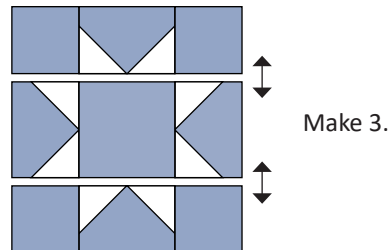

5. Sew the (3) star units together. Unit should measure 6 1/2" x 18 1/2".

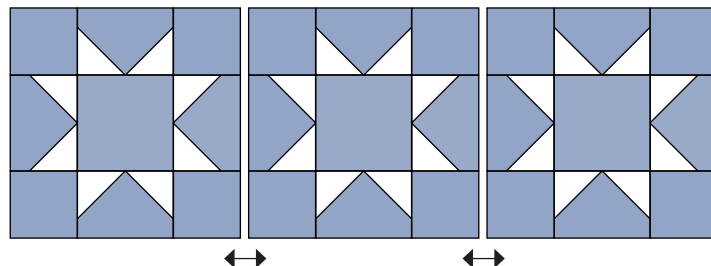

6. Sew (2) $1\frac{1}{2}'' \times 6\frac{1}{2}''$ blue strips to the left and right. Then sew (2) $1\frac{1}{2}'' \times 20\frac{1}{2}''$ blue strips to the top and bottom.

Press to the blue each time.

Unit should measure $8\frac{1}{2}'' \times 20\frac{1}{2}''$

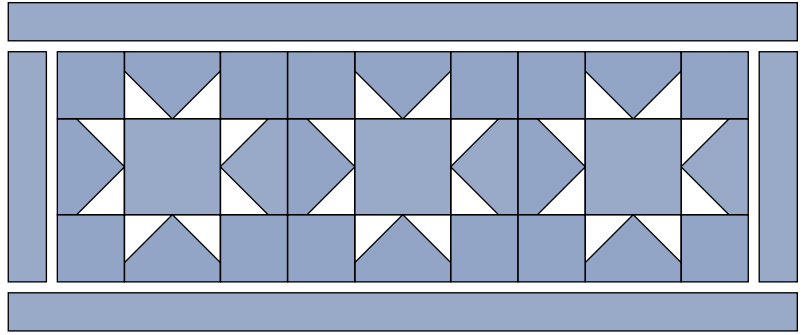

7. Make (2) piano key borders. Sew together:
 (16) $1\frac{3}{4}'' \times 3\frac{1}{2}''$ rectangles for the top border
 (16) $1\frac{3}{4}'' \times 3\frac{1}{2}''$ rectangles for the bottom border

Press open or to one direction, whichever you prefer.

Each unit should measure $3\frac{1}{2}'' \times 20\frac{1}{2}''$

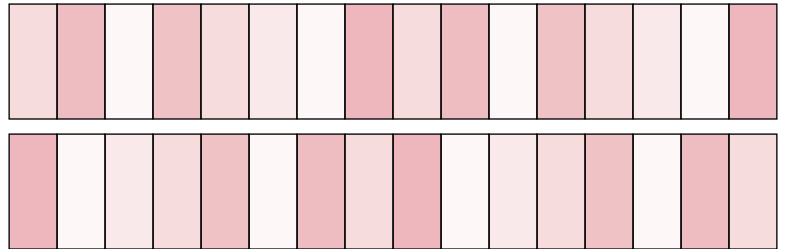

8. Sew the units from step 7 to the top and bottom of the unit from step 6.

Press to the blue.

Pillow top should measure $14\frac{1}{2}'' \times 20\frac{1}{2}''$.

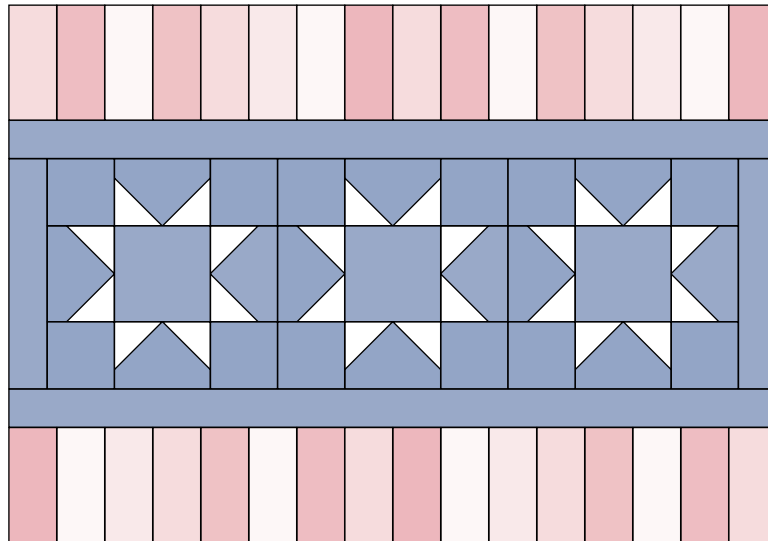

Finishing

Quilt and bind as desired.

Share your finished projects on
 Instagram using
 #*simplystarrypillow*

ALTERNATE FINISH:

If you wish to omit the piano key borders, simply add top and bottom borders that are $3\frac{1}{2}'' \times 20\frac{1}{2}''$.

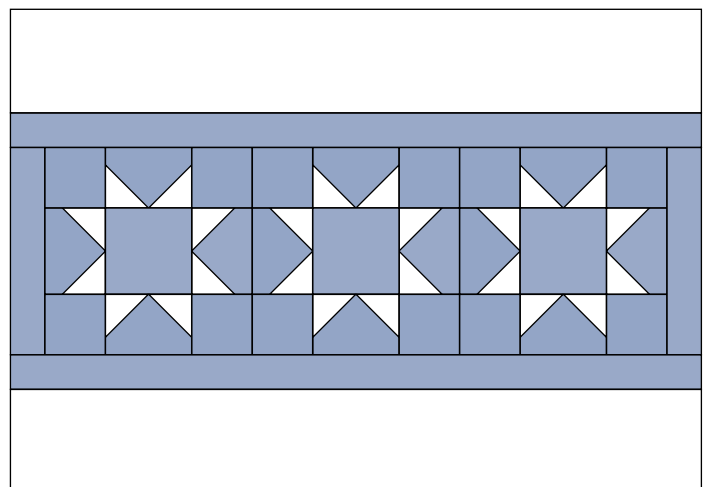

Pillow Assembly

Step 1

Quilt the pillow top as you would a mini quilt, using scrap yardage or inexpensive muslin as your backing.

After quilting, trim away batting and backing.

Step 2

Cut two backing pieces $14\frac{1}{2}'' \times 12\frac{1}{2}''$. Sew a 1'' hem on the right hand edge of one piece and sew a 1'' hem on the left hand edge of the other piece. (Figure A) These two pieces will overlap in the middle and need finished edges.

Step 3

Lay the pillow top **right side down** on your cutting mat. Then lay down the two backing pieces **right side up**. Overlap the two backing pieces so that when overlapped, the backing is the same size as the top. Adjust the backing pieces slightly to make sure all outer edges line up nicely. (Figure B)

Step 4

Pin around all four sides. Using a $\frac{1}{8}''$ seam allowance and a longer stitch length, sew baste around all four sides. This will keep everything in place for binding.

Step 5

Remove the pins and return to a $\frac{1}{4}''$ seam allowance and a regular stitch length. Bind the pillow just as you would any small quilt. This bound edge will create a sort of "piping" affect and finish your pillow nicely.

Step 6

Insert your pillow form through the back overlapped opening.

